

RECOMMENDED
PANEL CUT OUT

RoHS

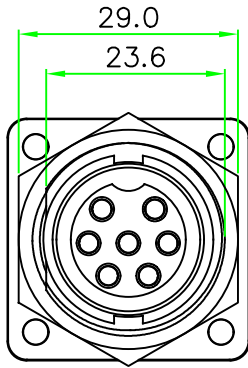

REV.	DESCRIPTION	DATE
A	ISSUE	Oct/21/2024

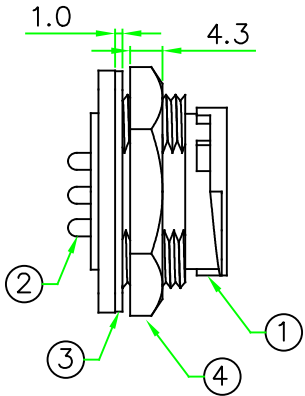
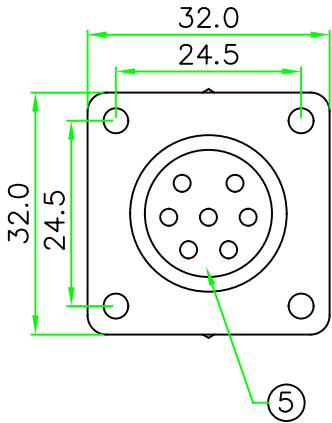
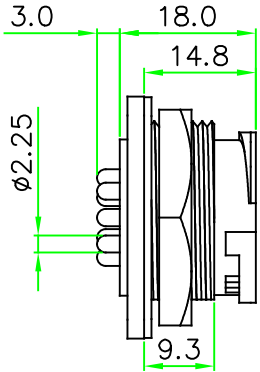
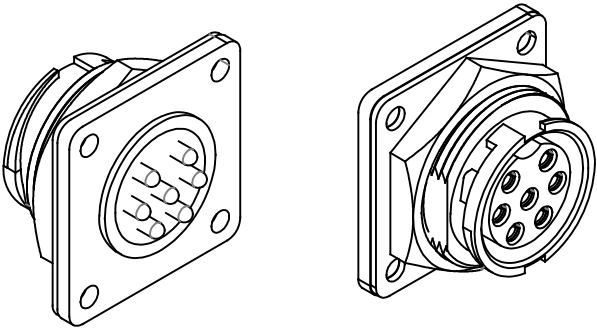

- NOTES:
- ELECTRICAL CHARACTERISTICS:
CURRENT RATING: 20A
CONNECTOR TEMPERATURE RANGE: -25°C TO +85°C
DIELECTRIC WITHSTANDING VOLTAGE:
500V AC FOR ONE MINUTE
 - PANEL THICKNESS MAX. 4.0mm
 - HOW TO ORDER: CDG-L3xxQPR

02 - 2 PINS 03 - 3 PINS
04 - 4 PINS 05 - 5 PINS
06 - 6 PINS 07 - 7 PINS

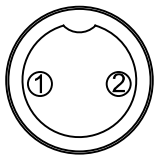

CDG-L302QPR

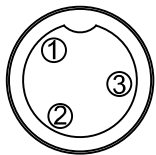

CDG-L303QPR

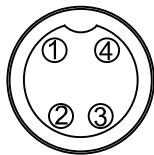

CDG-L304QPR

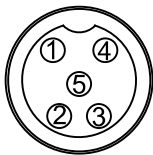

CDG-L305QPR

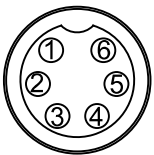

CDG-L306QPR

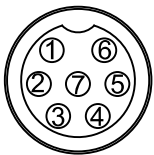

CDG-L307QPR

PIN ASSIGNMENT FRONT VIEW (前視圖)

5	GLUE	Epoxy.	BLACK	1	
4	HEX NUT	Nylon+GF.	BLACK	1	
3	GASKET	EPDM.	BLACK	1	
2	CONTACT	Brass, 6u" Gold Plating. Female Contact.		N	
1	CONNECTOR	D Size Male/Female Connector Insert, Nylon+GF.	BLACK	1	
No.	PART NAME	DESCRIPTION	COLOR	Q'TY	REMARKS

HOLIN® HTP ASIA TECHNOLOGY CO., LTD. 禾凌科技股份有限公司					
	UNIT: mm	TITLE D Size Male Connector Rear Mount Lock Type Square Flange PCB Pin			
SCALE	1:1	P/N: CDG-L3xxQPR		DR.	SIBYL
UNLESS OTHERWISE SPECIFIED TOLERANCES: .XX ± 0.5 .X ± 0.5 .XX ± 0.25 .XXX ± 0.1 ANGLE ± 1°		DWG.NO: CDG-L3xxQPR		CH.	JAMES
REV.	SHEET 1/1			AP.	