

RECOMMENDED  
PANEL CUT OUT

RoHS

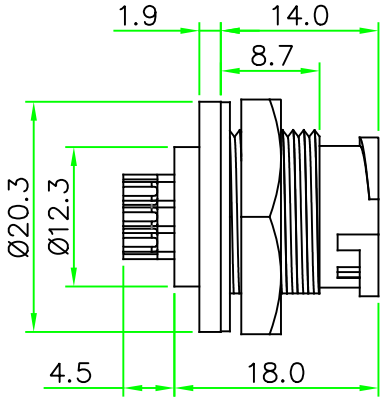

REV.	DESCRIPTION	DATE
A	ISSUE	Nov/23/2024

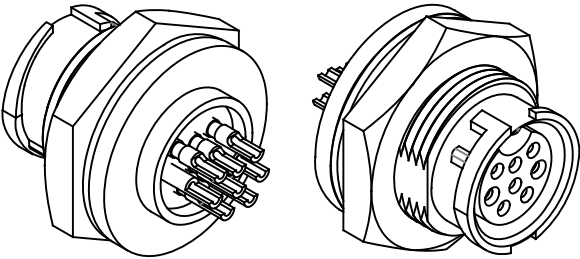

- NOTES:
- ELECTRICAL CHARACTERISTICS:  
CURRENT RATING: 2A / 5A  
CONNECTOR TEMPERATURE RANGE:  
-25°C TO +85°C  
DIELECTRIC WITHSTANDING VOLTAGE:  
500V AC FOR ONE MINUTE
  - PANEL THICKNESS : 4.0mm Max.

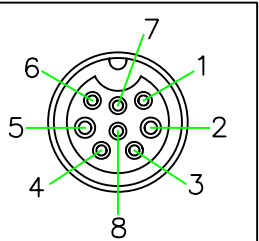

PIN ASSIGNMENT  
FRONT VIEW  
(前視圖)

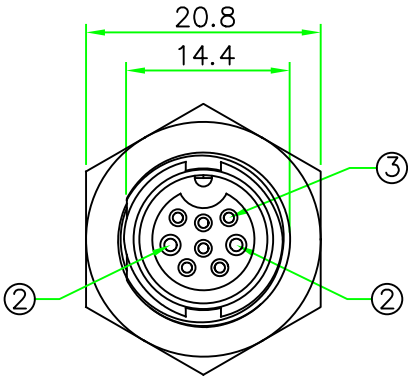
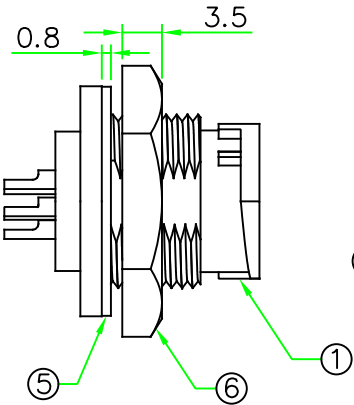
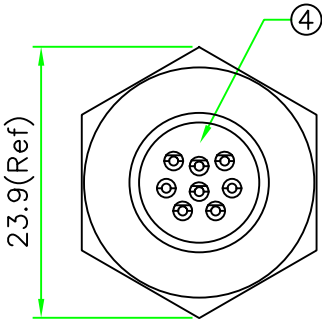

Notes : Gasket & Hex Nut does not assemble.Pack separately.  
(墊片及六角螺帽不組裝.分開包裝)

6	HEX NUT	Nylon + GF.	BLACK	1	
5	GASKET	EPDM.	BLACK	1	
4	GLUE	Epoxy.	BLACK	1	
3	CONTACT	BRASS , 6u" Gold Plated. Female Contact. (2A)		6	
2	CONTACT	BRASS , 6u" Gold Plated. Female Contact. (5A)		2	
1	CONNECTOR	B Size Male Connector Insert. Nylon+GF.	BLACK	1	
No.	PART NAME	DESCRIPTION	COLOR	Q'TY	REMARKS

**HOLIN®** HTP ASIA TECHNOLOGY CO., LTD.  
禾凌科技股份有限公司

	UNIT: mm	TITLE Circular B Size Male Connector Female Pin Rear Mount Lock Type Round Flange Solder Bucket Pin	
SCALE	1.5:1		
UNLESS OTHERWISE SPECIFIED TOLERANCES: .XX ± 0.5 .X ± 0.5 .XX ± 0.25 .XXX ± 0.1 ANGLE ± 1°		P/N:	DR. JAMES
		CBDN-L326CSR	CH. ERIC
REV.	SHEET	DWG.NO:	AP.
A	1/1	CBDN-L326CSR	